

KP101B intelligent desktop ionizing blower

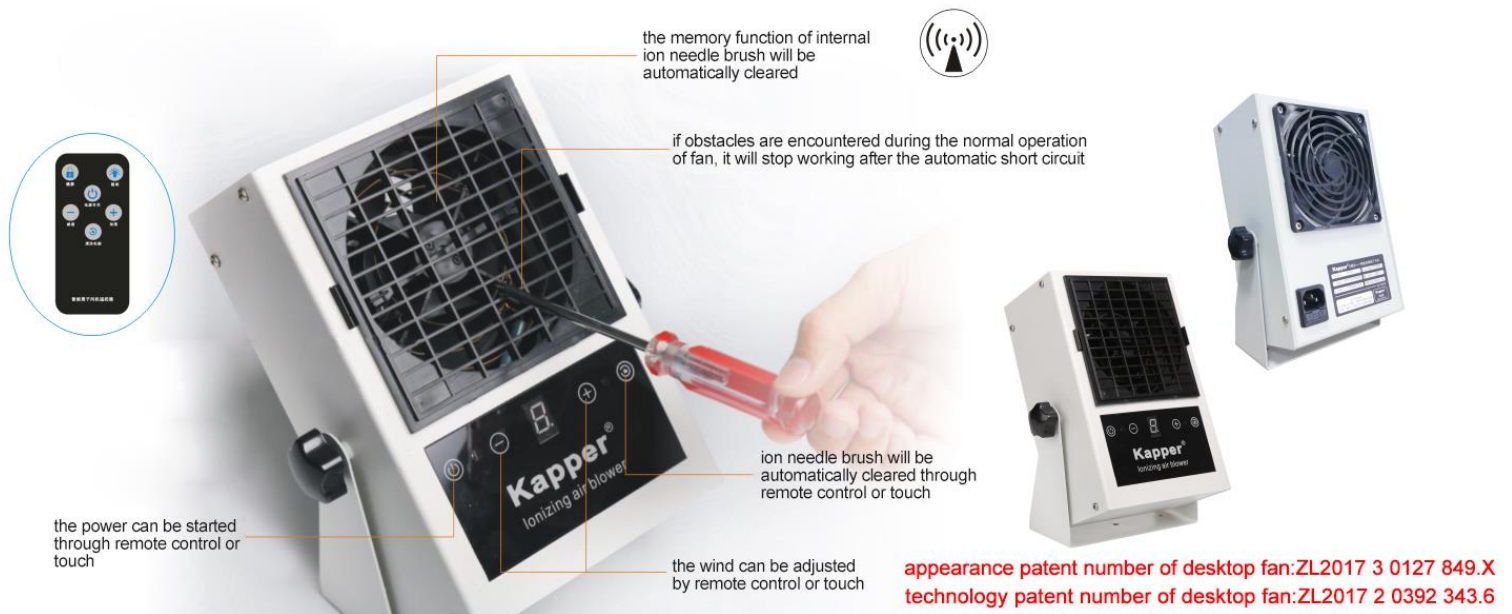

FEATURES

1. Intelligent and modern with dedicate appearance, fine manufacture and novel design.
2. Automatic cleaning and automatic learning function of transmitting needle brush, hand cleaning is unnecessary.
3. Both the power start and wind regulation can be controlled by remote control or touch.
4. Wind sounding alarm and alarm lamp function for high voltage fault, helping us understand whether the equipment is working normally from auditory sense and vision.
5. If obstacles are encountered during the normal operation of fan, it will stop working after the automatic short circuit.
6. Fast elimination of static electricity, low balance voltage and high safety performance.
7. Energy saving and environmental with low power consumption.

OPERATION MODE

Appearance	Fan angle control screw hole is reserved on the side	/
	Material	Cold rolled plate
	Surface	Electrostatic spray paint
	Front plastic windshield	It can be disassembled freely.
	Rear plastic windshield	Filter network is optional
	Casing grounded	No electricity leakage
	Include the size of bracket	186mm(L)*100mm(W)*240mm(H)
	Not include the size of bracket	146mm(L)*88mm(W)*222mm(H)
Static electricity facilities	Automatic cleaning of discharge needle	/
	Discharge needle material	Tungsten alloy, non-detachable
	Power consumption time	≤2S(300mm from the product)
	Ion balance	≤ ±10V (300mm from the product)
	Connection mode	Frequency conversion AC 5 .0KV
	The effective control diameter for static electricity elimination is 300mm	300mm from the product
	Cleaning brush	Antistatic material, no abrasion or picking
Blower	Fan air volume ≤5.1m ³ /min	300mm from the product
	Power	8W
	Working distance	100—600mm
	Working temperature	0-50℃
	Working humidity	56%-65%
	Air velocity	45-110CFM
	Noise	45-55dB
	Net weight	About 2.5kg
	Gross weight	About 3.1kg
Other	One year of warranty	

Testing condition			
Humidity: $\leq 60\%$		Testing voltage: 1KV-100V	
		Temperature: 22°C	
Distance		300mm	600mm
Decay time	Positive	0.5s	0.8s
	Negative	0.5s	0.7s
Offset voltage	Positive	+6V	+8V
	Negative	-8V	-7V

* The test result by ME268A comprehensive electrostatic tester shall prevail.

* Test according to IEC - 61340-5-1 A 6.

* Test data may change with the surrounding temperature and humidity.

INSTALLATION WAY

